

# Malmö 100 cabinet with countertop

SKU: 30010197

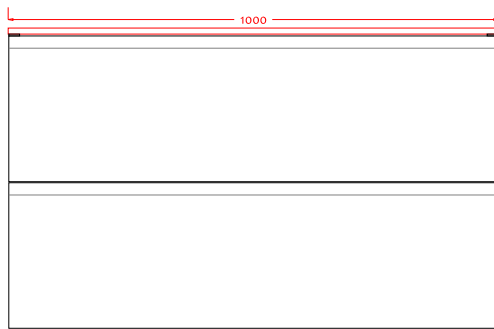

// ELEVATION

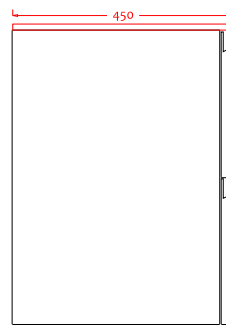

// Side VIEW

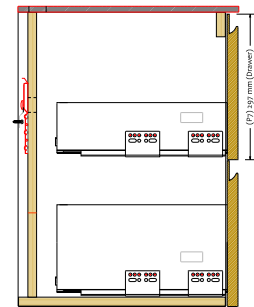

// Side SECTION

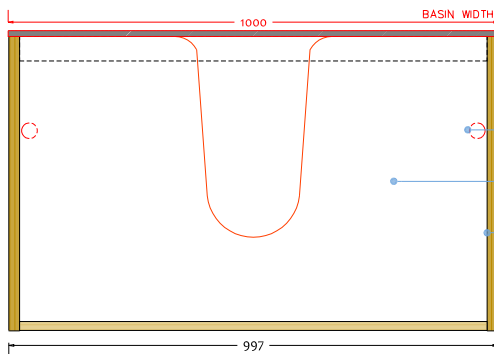

// SECTION

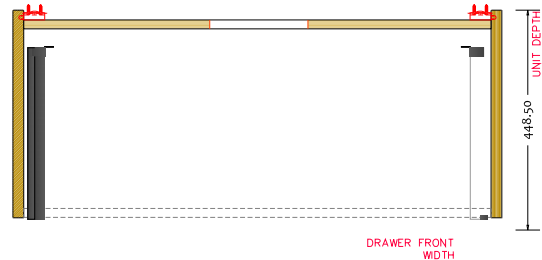

DRAWER FRONT WIDTH

<b>Colour:</b>	Matte white
<b>Size H/L/D:</b>	60cm / 100cm / 45cm
<b>Weight:</b>	56,45kg nett

## Malmö 100 cabinet with countertop details:

Timeless bathroom furniture with two large drawers, fitted with Soft-Close Hettich Rails. For Malmö, we use a narrow water trap that sits right up under the sink to maximize space in the drawer. The drawers therefore have no cut-out for water trap.